



3 East Victoria Street SHEFFIELD TAS

3 1 2

Situated in the picturesque town of Sheffield on 960m2(Approx.) with direct views of Mount Roland. Inside hosts 3 Spacious Bedrooms, a recently updated living room flowing into a contemporary kitchen/dining room. There's a modern bathroom, large laundry, 2 toilets and a utility room offering everything you need and more.

Outside is a large undercover outdoor entertaining area perfect for family gatherings with views of a beautiful countryside backdrop. The 2 door garage (6x9) has surplus room for 2 cars and a workshop area.

Ideal location just a short walk to the Sheffield Football Ground and a short drive to the town Centre.

Type : House
Land Size : 960 sqm
View : <https://www.mbre.com.au/sale/tas/burnie-de-voport-nw-tas/sheffield/residential/house/7328400>

[For full version visit the website](https://www.mbre.com.au)

<https://www.mbre.com.au>

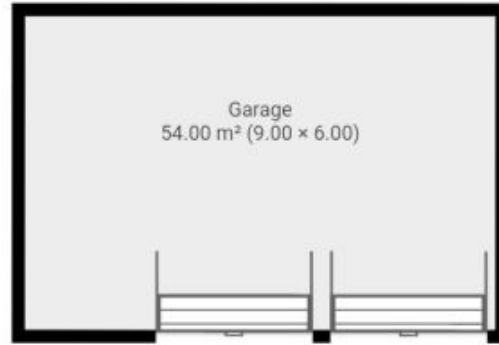
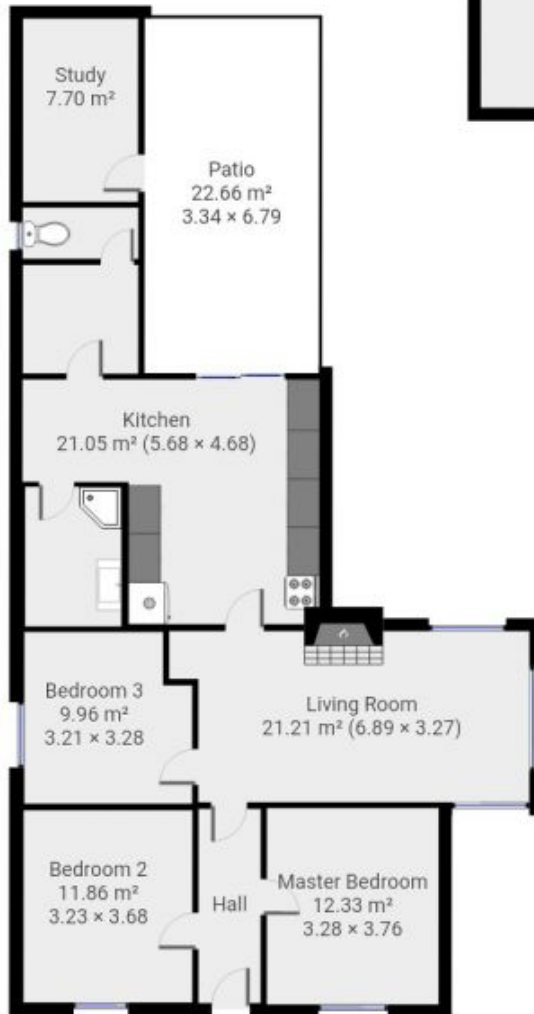

Michael Burr & Assoc This floor plan is to be used as a guide only.