



46 Lawrence Drive DEVONPORT TAS

3  2  3 

Situated on a large 1568sqm (Approx.) parcel of land is this Brick Family Home built in 2004, only a short drive to everything Devonport has to offer. This home has been well loved over the years from the landscape to the immaculate condition of the house. For those looking for a family home with it all that is low maintenance then this one is for you, move right in and enjoy the large property so close to town.

Land Size : 1526 sqm
View : <https://www.mbre.com.au/sale/tas/burnie-devonport-nw-tas/devonport/residential/house/7328490>

You walk in to a large open plan living / dining area equipped with a reverse cycle heat pump to keep cosy all year round. The home features 3 Large bedrooms all with built in robes and the Master hosting an en suite. A single bathroom ties the remaining 2 bedrooms together and a the laundry space features a seperate toilet & basin. Flowing off the dining room is an undercover deck area overlooking bushland, the ideal summer gathering/bbq area. Under the

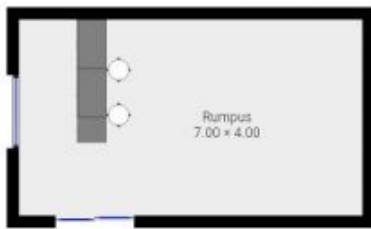

*Under House

